

TO TEST

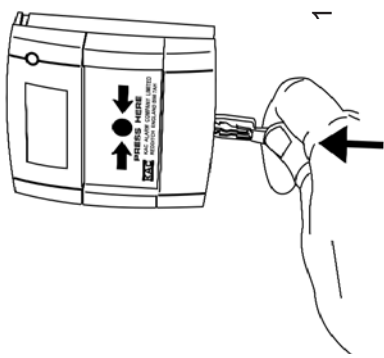

1

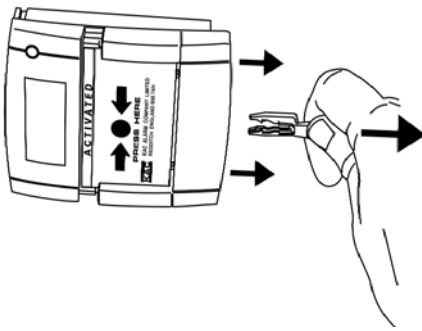

2

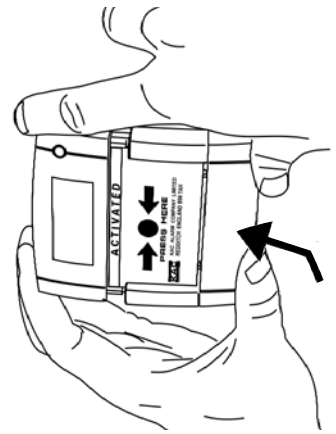

3

TO REPLACE GLASS / RESETTABLE ELEMENT

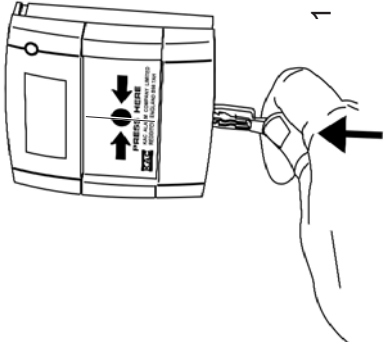

1

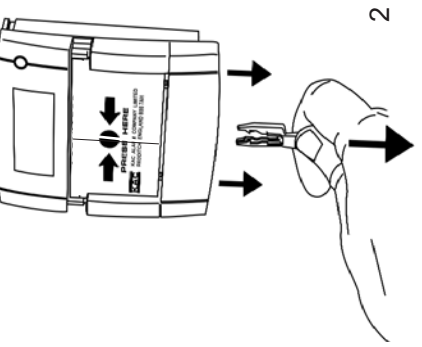

2

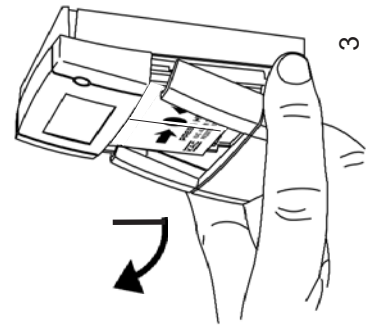

3

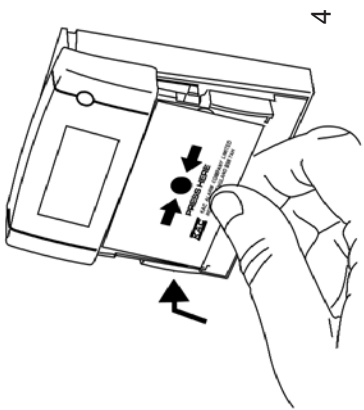

4

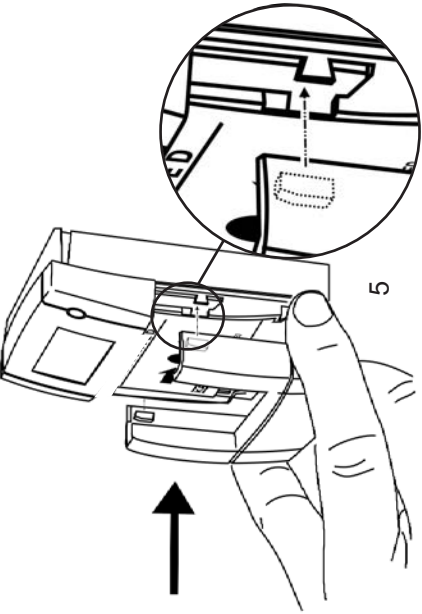

5

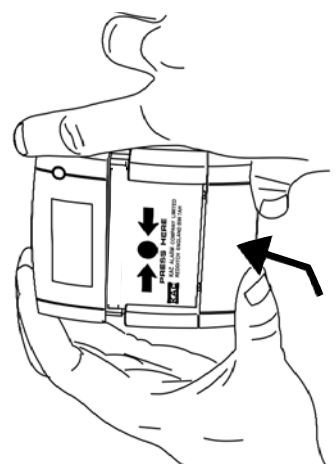

6

TO RESET

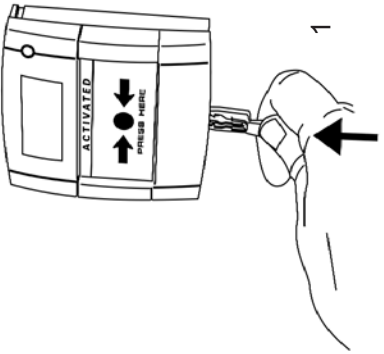

1

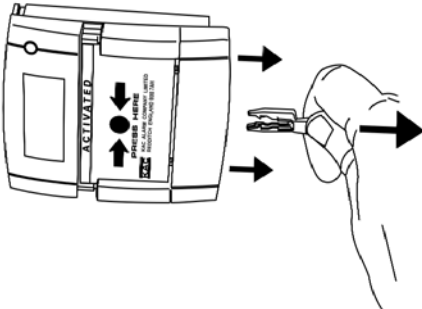

2

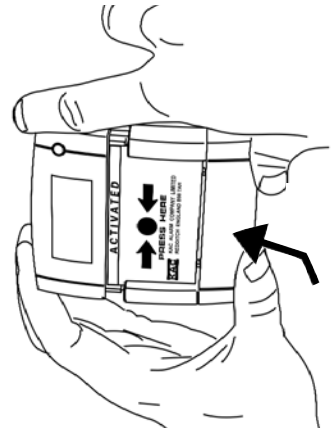

3

KAC INSTALLATION INSTRUCTIONS FOR THE MANUAL CALL POINT MODELS MCP1.....,MCP2.....,MCP3.....,MCP4.....

CONNECTION DETAILS	MCP1A-X	MCP1B-X	MCP2A-X	MCP2B-X

X in the MCP code (left) represents the final digits of the part number, which indicate MCP colour, component values, mounting options and element type.

eg MCP1A -R470SF = (MCP1A, Red, 470R, Surface, Flexible Element).

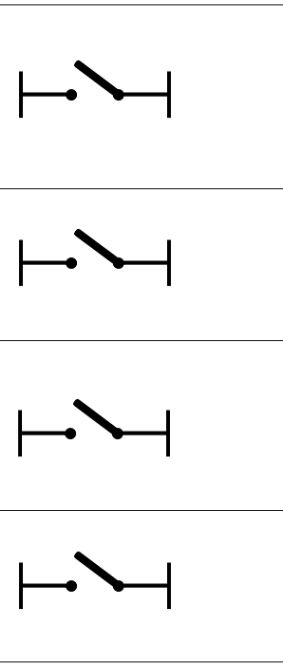
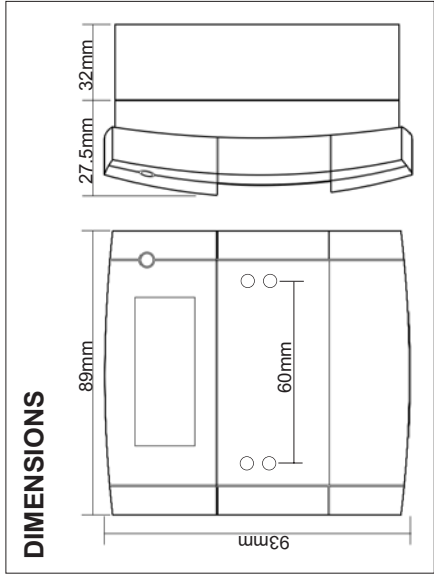

CONNECTION DETAILS	MCP3A-X	MCP4A-X

TECHNICAL DATA

- 30VDC Max
- 2A Max
- IP24D
- 110/160g

TEMPERATURE

-10°C to 55°C

COLOURS

- Red, Ral 3001
- Yellow, Ral 1006
- Green, Ral 6016
- White, Ral 9010
- Blue, Ral 5002

IMPORTANT NOTE:
PLEASE DO NOT OVER TIGHTEN FIXING SCREWS

D700 issue 4