

RLX™
FLOODLIGHT
Proven endurance

luminell®
Light Matters

Photo: Seonics

Powerful LED floodlights for extreme environments

- Flicker Free
- Made to handle shocks and vibrations over time
- Seawater resistant and "easy clean" design
- No maintenance
- Designed and produced in Scandinavia
- Dimmable
- Compact, robust and sealed
- Excellent EMC characteristics
- Encapsulated internal electronics
- No ballast required
- Available for hazardous areas
- Corrosion class C5m

5
YEAR
WARRANTY



RLX™ B
FLOODLIGHT



RLX™ C
FLOODLIGHT



RLX™ D
FLOODLIGHT Gen2

NEW
PRODUCT



RLX™ D
FLOODLIGHT Gen3

100-277 VAC

RLX™ C
FLOODLIGHT

RLX™ D
FLOODLIGHT Gen2

RLX™ D
FLOODLIGHT Gen3

Input Specifications

Input voltage range	100 - 277 VAC	100 - 277 VAC	100 - 277 VAC
Frequency range	50 - 60 Hz	50 - 60 Hz	50 - 60 Hz
Rated power	80W	160W	240W
Alternative rated power	40W ¹	N/A	N/A
Current at 230VAC	0,35 A (80W)	0,75 A	1,04 A
Leakage current	<0,75 mA /227 VAC	<0,75 mA /227 VAC	0,5 mA /230 VAC
Inrush current (50% I-peak @ 230VAC)	~65A (445 μs)	~65A (445 N/A)	200A (150 μs)
Light Control / DIM	Optional: 0-100KΩ or 0-10V (5-100%)	N/A	0-100KΩ, 0-10V or 0-10VDC (0-100%)

Light Specifications

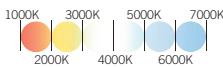
Initial luminous flux @ Ta 25°C	10.776	21.552	30.684
Color rendering index (CRI)	min. 70	min. 70	min. 70
Color temperature 	5.000 K (+ - 500 K) ²	5.000 K (+ - 500 K) ²	5.000 K (+ - 500 K)
Beam angles	10° spot beam - 110° wide beam (see last page)		

General Specifications

Startup time	1 sec.	1 sec.	1 sec.
Operating ambient temperature (Ta)	- 40°C to + 55°C	- 40°C to + 55°C	- 40°C to + 55°C
Storage temperature	- 40°C to + 80°C	- 40°C to + 80°C	- 40°C to + 80°C
Weight (apx.)	6.5 kg	10.5 kg	14,5 kg
Cable gland	1xM20 (6-13mm)	1xM20 (6-13mm)	1xM20 (6-13mm)
Blind caps	1xM20	1xM20	1xM20, 2xM25
IP class	IP 66/67	IP 66/67	IP 66/67
Lifetime prediction (L70) @ Ta 45°C	110.000 hrs	110.000 hrs	110.000 hrs
Corrosion class	C5m ISO 9223/12944 (for offshore and maritime environments) For more information see document "Lifetime Prediction RLX™." on our website.		



Materials

Body / casing / chassis	Seawater resistant; casted, anodized, and powder coated aluminium
Glass	Tempered glass (Polycarbonate on request)
Bracket, bolts, nuts, etc.	Stainless steel AISI 316L (1.4404), A4

Other Compliances

Description	Standard
LED modules for general lightning	IEC 62031
Photobiological safety	IEC 62471: 2009 (Low risk - RG1)
EMC radiated emissions	DNVGL EMC Class A and B - IEC/EN 60945
Radiated and conducted	MIL-STD461F/G CE102 and RE102 (Only RLX D with protection guard)
EMC immunity	EN 61000-4-2,3,4,5,6,8,11 (Surge 4 kV)
ETL / cETL certified	EANSI/UL1598, ANSI/UL1598A, ANSI/UL 8750 and CSA C22.2 No.250.0

¹ On request

² Also available in 3.000 K (Warm White)

	12/24VDC		24VDC
	RLX™ B FLOODLIGHT	RLX™ C FLOODLIGHT	RLX™ D FLOODLIGHT Gen2
Input Specifications			
Input voltage range	9 - 36 VDC	19 - 30 VDC	19 - 30 VDC
Rated power	40W	80W / 120W	160W / 240W
Current at 24V	1,6A	3,33A / 5A	6,67A / 10A
Light Control / DIM	N/A	0-100KΩ or 0-10V (0-100%)	0-100KΩ or 0-10V (0-100%)
Light Specifications			
Initial luminous flux @ Ta 25°C	5.000	10.600 / 14.000	21.200 / 28.000
Color rendering index (CRI)	min. 70	min. 70	min. 70
Color temperature	5.000 K (+ - 500 K)	5.000 K (+ - 500 K)	5.000 K (+ - 500 K)
Beam angles	40° + 60° beam	10° spot beam - 110° wide beam (see last page)	
General Specifications			
Startup time	1 sec.	1 sec.	1 sec.
Operating ambient temperature (Ta)	- 40°C to + 55°C	- 40°C to + 55°C	- 40°C to + 55°C
Storage temperature	- 40°C to + 80°C	- 40°C to + 80°C	- 40°C to + 80°C
Weight (apx.)	1,5 kg	6.5 kg	10.5 kg
Cable gland	3m 2x1,5mm ² cable	1xM20 (6-13mm)	1xM20 (6-13mm)
Blind caps	N/A	1xM20	1xM20
IP class	IP 66/67/68	IP 66/67	IP 66/67
Lifetime prediction (L70) @ Ta 45°C	110.000 hrs	110.000 hrs	110.000 hrs
Corrosion class	C5m ISO 9223/12944 (for offshore and maritime environments) For more information see document "Lifetime Prediction RLX.." on our website.		
Materials			
Body / casing / chassis	Seawater resistant; casted, anodized, and powder coated aluminium		
Glass	Tempered glass (Polycarbonate on request)		
Bracket, bolts, nuts, etc.	Stainless steel AISI 316L (1.4404), A4		
Other Compliances			
Description	Standard		
LED modules for general lightning	IEC 62031		
Photobiological safety	IEC 62471: 2009 (Moderate risk - RG2) Do not stare at light source		
EMC radiated emissions	DNVGL EMC Class A and B - IEC/EN 60945		
Radiated and conducted	MIL-STD461F/G CE102 and RE102 (Only RLX D with protection guard)		
EMC immunity	EN 61000-2,3,4,6,8 (Surge 2 kV)		
ETL / cETL certified	ANSI/UL1598, ANSI/UL1598A, ANSI/UL 8750 and CSA C22.2 No.250.0 (not RLX B)		



Dimensions and Mounting

Front view	Fig.1	Fig.2	Fig.3	Fig.4
Side view	Fig.5	Fig.6	Fig.7	Fig.8
Bracket	Fig.9	Fig.10	Fig.11	Fig.12

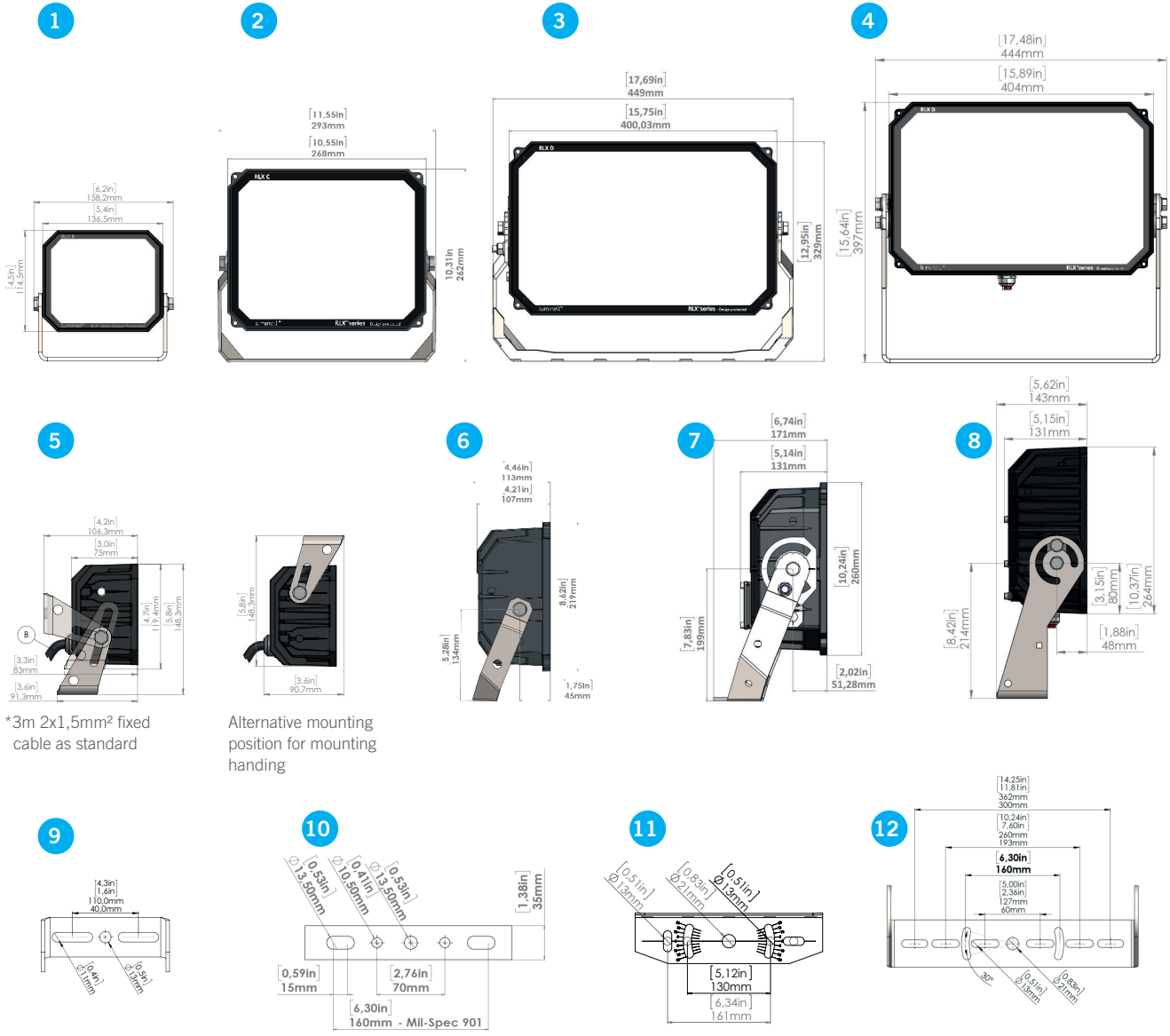

*3m 2x1,5mm² fixed cable as standard

Alternative mounting position for mounting handing

Options and Accessories

- Anti-Ice kit
- Specialized products on request
- RLX B available in 6 pack



Protection grid

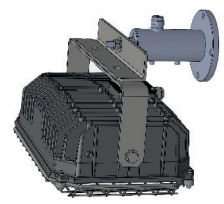

Damper (Pendulum mounting)

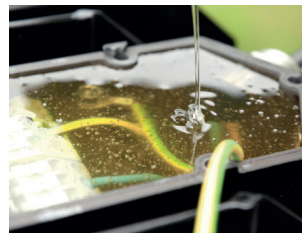

Connection Box Gel KIT (Only RLX D gen3)

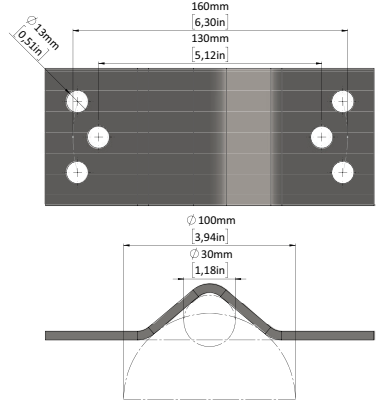

Pole mount bracket Ø30-100mm

RLX™ Series, standard beam alternatives

Beam group	Beam code	Light projection – diameter, 10m distance	Color code
Spot beams	Spot10	2m	●
	Spot20	3m	
Medium beams	Medium30	5,4m	●
	Medium40	7m	
	Medium60	10m	
Wide beams	Wide	28m	●
	WideOffset	34m	
Oval beams	OvalH	8,2 x 2m	●
	OvalV	2 x 8,2m	

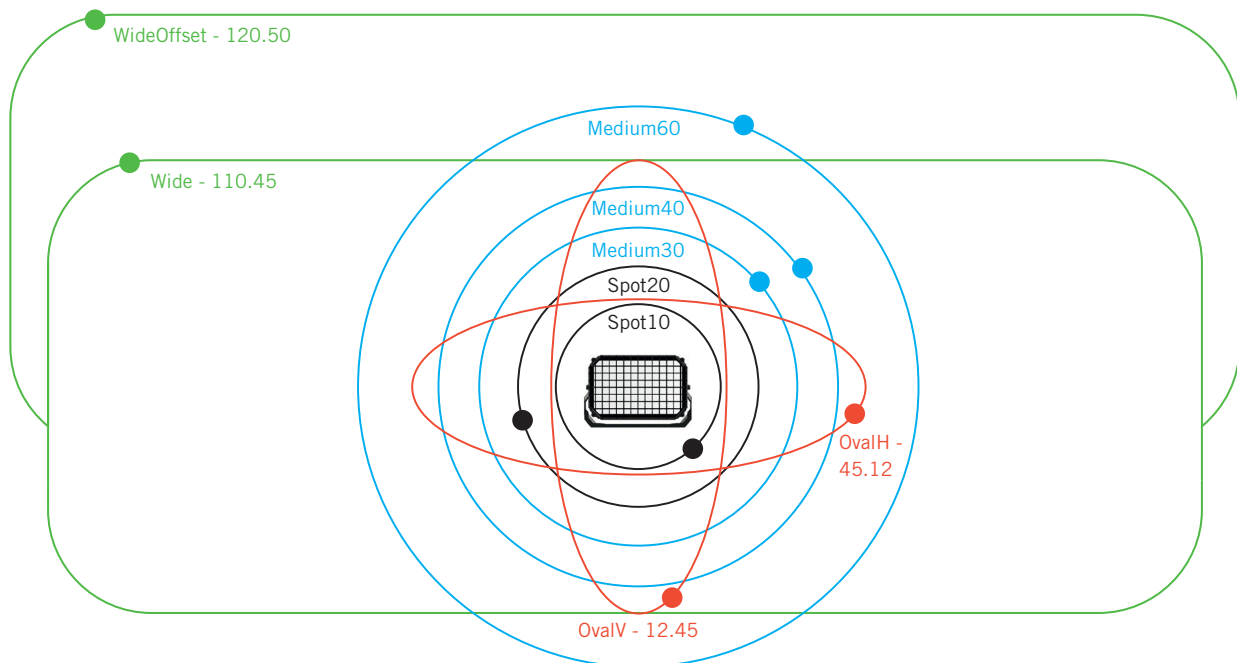

Specifications are subject to change at any point without prior notice.